



Yuasa Scheda Tecnica

Yuasa YB12AL-A - YuMicron Batteria

Prestazione

Tensione	12
Capacità (10 ore)	12Ah
Capacità (20 ore)	12.6Ah
CCA @ -18°C	150A

Dimensioni (±2mm)

Lunghezza	136mm
Profondità	82mm
Altezza	162mm

Pesi e Misure

Peso medio con acido	4kg
Volume dell'acido	0.8l

Tecnologia

Tecnologia	Piastra Sb/Sb
Separatore	Synthetic Resin+Glass Fiber



Schema di Collegamento

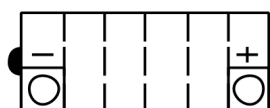

Tipologia dei terminali - 6

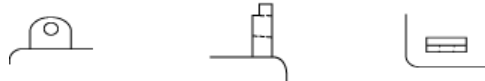

Scheda tecnica prodotta su E&OE



Yuasa Technical Data Sheet

Yuasa YB12AL-A - YuMicron Battery

Performance

Voltage	12
Capacity (10-hour)	12Ah
Capacity (20-hour)	12.6Ah
CCA @ -18°C	150A

Dimensions (±2mm)

Length	136mm
Width	82mm
Height	162mm

Weights & Measures

Mean Weight with Acid	4kg
Acid Volume	0.8l

Technology

Technology	Cast Sb/Sb
Separator	Synthetic Resin+Glass Fiber



Cell Assembly Layout

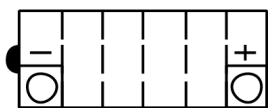

Terminal Type - 6

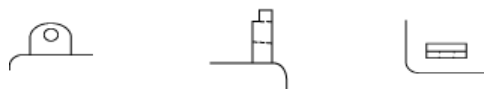

Data Sheet generated on 11/08/2022 - E&OE