



Yuasa Scheda Tecnica

Yuasa YB7-A - YuMicron Batteria

Prestazione

| | |
|-------------------|-------|
| Tensione | 12 |
| Capacità (10 ore) | 8Ah |
| Capacità (20 ore) | 8.4Ah |
| CCA @ -18°C | 105A |

Dimensioni (±2mm)

| | |
|------------|-------|
| Lunghezza | 136mm |
| Profondità | 75mm |
| Altezza | 133mm |

Pesi e Misure

| | |
|----------------------|------|
| Peso medio con acido | 3kg |
| Volume dell'acido | 0.6l |

Tecnologia

| | |
|------------|---------------|
| Tecnologia | Piastra Sb/Sb |
| Separatore | Leaf |



Schema di Collegamento

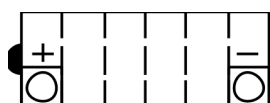

Tipologia dei terminali - 6

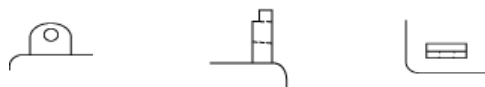

Scheda tecnica prodotta su E&OE



Yuasa Technical Data Sheet

Yuasa YB7-A - YuMicron Battery

Performance

| | |
|--------------------|-------|
| Voltage | 12 |
| Capacity (10-hour) | 8Ah |
| Capacity (20-hour) | 8.4Ah |
| CCA @ -18°C | 105A |

Dimensions (±2mm)

| | |
|--------|-------|
| Length | 136mm |
| Width | 75mm |
| Height | 133mm |

Weights & Measures

| | |
|-----------------------|------|
| Mean Weight with Acid | 3kg |
| Acid Volume | 0.6l |

Technology

| | |
|------------|------------|
| Technology | Cast Sb/Sb |
| Separator | Leaf |



Cell Assembly Layout

Terminal Type - 6

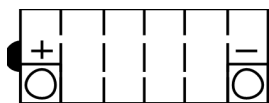

Data Sheet generated on 25/09/2022 - E&OE